

FEBRILE ANTIGENS

Widal Wright - Weil Felix - Listeria

The complete solution for serological diagnosis of Typhoid and Paratyphoid infections, Brucellosis, Rickettsiosis and Listeriosis.



Rapid test



Tube titration

PRINCIPLE

The serological diagnosis of infectious diseases characterized by persistent fever is based on the agglutination reaction which undergoes between the antigen and specific antibodies which may be present in the patient's serum.

The Widal reaction allows the diagnosis of infections caused by *Salmonella typhi*, *Salmonella paratyphi* Groups A, B and C. The method has been further developed through the adoption of the somatic O and flagellar H antigens.

The Wright reaction allows the diagnosis of *Brucellosis* (Maltese or Mediterranean Fever) caused by 3 strains of *Brucella* (*melitensis*, *abortus* and *suis*).

The Weil-Felix reaction allows the diagnosis of Rickettsiosis and is based on the fact that three strains of *Proteus* (OX19, OX2 and OXK), which share somatic antigenic components with *Rickettsia*, are agglutinated by antibodies present in the serum of infected patients.

Listeria plus is a tube agglutination assay for titration of antibodies against *Listeria*.

reliable ■ rigorous controls on the antigenic characteristics of bacterial strains used guarantee high sensitivity and specificity of the reaction

easy interpretation ■ the stable coloured bacterial suspensions allow unequivocal readings in both the rapid slide tests and the microplate titrations

concordance of results ■ results obtained with the rapid test and with the microplate titration method are in agreement with the reference test-tube method

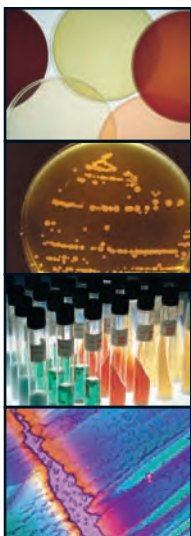

Rapid Test

SCREENING

PROCEDURE

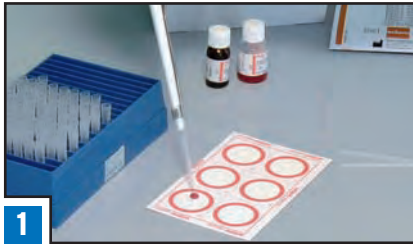

1 Dispense 50 µl of coloured suspension and 50 µl of serum on the slide.



2 Using a mixing stick, mix the serum with the suspension over the whole reaction area.

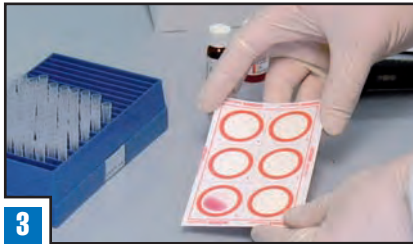

3 Gently shake the card for 1 minute.



4 Reading of the results.
Sample 5: positive
Sample 6: negative

TITRATION

PROCEDURE



1 Distribute the test serum in agreement with the scheme shown in the figure, then add 50 µl of coloured suspension to each reaction site.

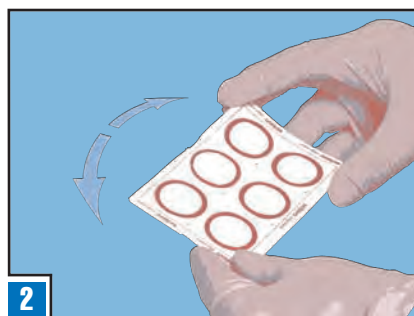

2 Gently shake the card for 1 minute before reading the results.

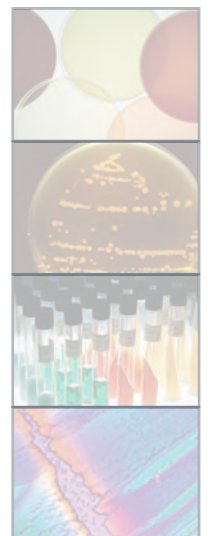

Titration

TUBE PROCEDURE

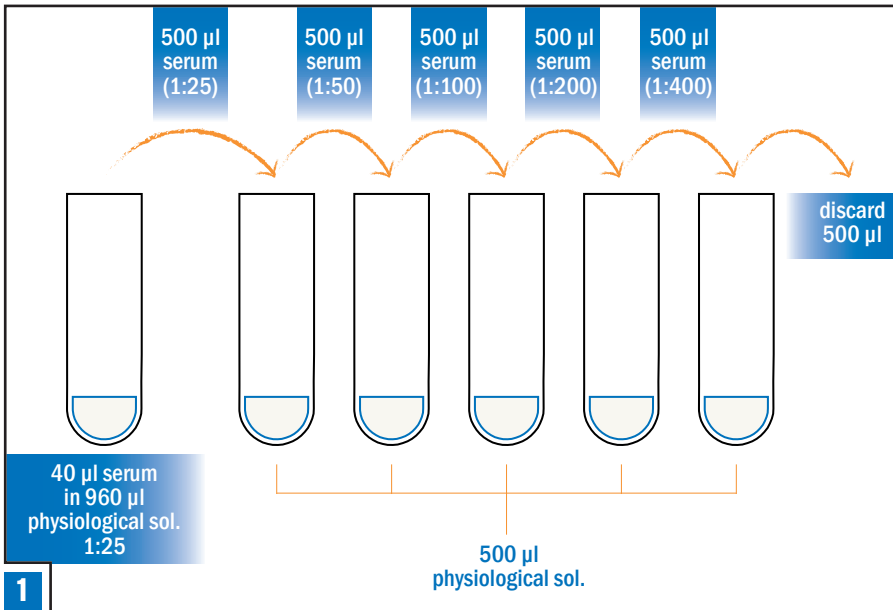

Prepare doubling dilutions in test tubes as shown in figure.

2

Add 500 µl of coloured suspension and incubate at 37°C for 18 hours in a humid chamber.

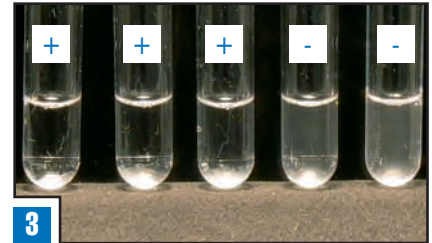

Reading of results.

Microplate titration test

PROCEDURE

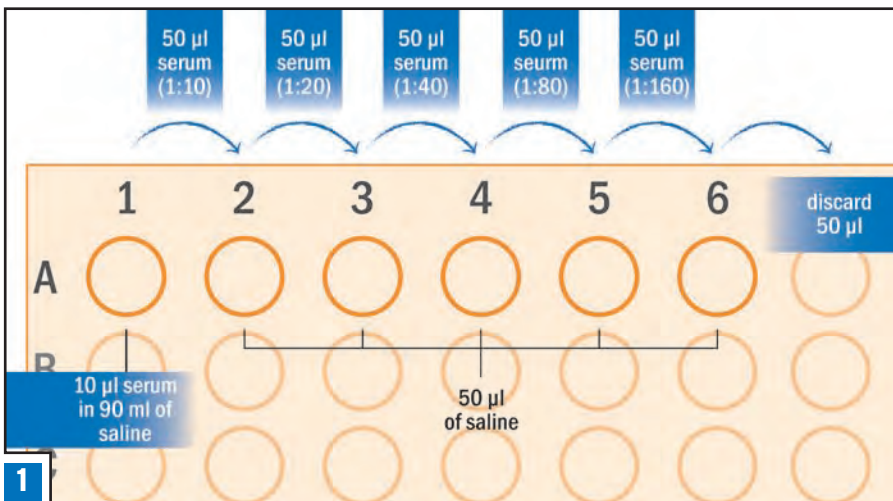

Prepare doubling dilutions in a microplate as shown in the figure.

2

Add 50 µl of coloured suspension and incubate at 37°C for 18 hours in a humid chamber.

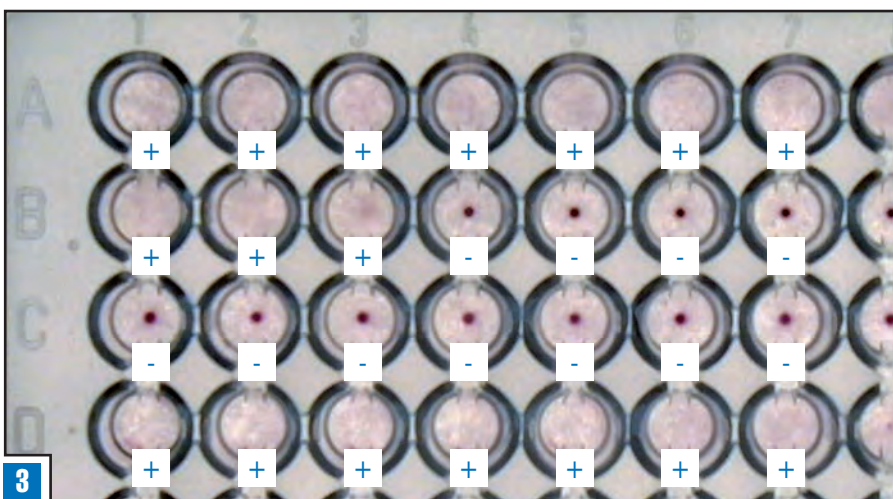

Reading of results.

WIDAL WRIGHT

Coloured suspensions on slide

CSI087309	Febrile Antigen	7 antigens x 3 ml	420 tests
<i>Multiple kit containing the antigens CSI087301, CSI087302, CSI087303, CSI087305, CSI087306, CSI087308, positive and negative controls</i>			

Single Components

CSI087401	Brucella	6 ml	120 tests
CSI087402	S. typhi antigen O	6 ml	120 tests
CSI087403	S. typhi antigen H	6 ml	120 tests
CSI087405	S. paratyphi B antigen O	6 ml	120 tests
CSI087406	S. paratyphi B antigen H	6 ml	120 tests
CSI087407	S. paratyphi A antigen O	6 ml	120 tests
CSI087408	S. paratyphi A antigen H	6 ml	120 tests
CSI087409	S. paratyphi C antigen O	6 ml	120 tests
CSI087410	S. paratyphi C antigen H	6 ml	120 tests

Colourless suspensions for tube testing

CSI087201	S. typhi total	20 ml	40 tests
CSI087202	S. typhi antigen O	20 ml	40 tests
CSI087203	S. typhi antigen H	20 ml	40 tests
CSI087204	S. paratyphi total	20 ml	40 tests
CSI087205	S. paratyphi A antigen O	20 ml	40 tests
CSI087206	S. paratyphi A antigen H	20 ml	40 tests
CSI087207	S. paratyphi B total	20 ml	40 tests
CSI087208	S. paratyphi B antigen O	20 ml	40 tests
CSI087209	S. paratyphi B antigen H	20 ml	40 tests
CSI087210	S. paratyphi C total	20 ml	40 tests
CSI087211	S. paratyphi C antigen O	20 ml	40 tests
CSI087212	S. paratyphi C antigen H	20 ml	6 tests
CSI087213	Brucella	20 ml	40 tests

Colourless suspensions for microplate test

CSI087310	Antigen Set	5 antigensx5 ml	5x100 tests
<i>Multiple kit containing the antigens CSI087230, CSI087234, CSI087233, CSI087232, CSI087231 and polyvalent positive control</i>			

Single Components

CSI087230	Brucella	3x5 ml	300 tests
CSI087231	S. paratyphi B total	3x5 ml	300 tests
CSI087232	S. paratyphi A total	3x5 ml	300 tests
CSI087233	S. typhi antigen H	3x5 ml	300 tests
CSI087234	S. typhi antigen O	3x5 ml	300 tests
CSI087235	S. typhi total	3x5 ml	300 tests
CSI087236	S. paratyphi C total	3x5 ml	300 tests
CSI087237	S. paratyphi C antigen O	3x5 ml	300 tests
CSI087238	S. paratyphi C antigen H	3x5 ml	300 tests
CSI087311	S. paratyphi A antigen O	3x5 ml	300 tests
CSI087312	S. paratyphi A antigen H	3x5 ml	300 tests
CSI087313	S. paratyphi B antigen O	3x5 ml	300 tests
CSI087314	S. paratyphi B antigen H	3x5 ml	300 tests

Coloured suspensions for slide, tube and microplate testing

CSI087370	Febrile Antigen Multi Kit	7x3 ml	
<i>Multiple kit for rapid screening slide testing and microplate or tube titration of specific bacterial antibodies.</i>			
<i>Kit includes antigens CSI087371, CSI087373, CSI087374, CSI087376, CSI087377, CSI087379, CSI087380, positive control CSI087387 and negative control CSI087388</i>			

Single Components

CSI087471	M.K. Brucella	6 ml
CSI087473	M.K. Salmonella typhi antigen O	6 ml
CSI087474	M.K. Salmonella typhi antigen H	6 ml
CSI087476	M.K. Salmonella paratyphi A antigen O	6 ml
CSI087477	M.K. Salmonella paratyphi A antigen H	6 ml
CSI087479	M.K. Salmonella paratyphi B antigen O	6 ml
CSI087480	M.K. Salmonella paratyphi B antigen H	6 ml
CSI087481	M.K. Salmonella paratyphi C antigen O	6 ml
CSI087482	M.K. Salmonella paratyphi C antigen H	6 ml
CSI087387	M.K. polyvalent positive control	2 ml
CSI087388	M.K. negative control	2 ml

WEIL FELIX

Colourless suspensions for tube testing

CSI087252	Proteus kit	3 antigensx20 ml	3x40 tests
<i>Multiple kit containing the antigens OX19, OX2, OXK</i>			

Colourless suspensions for microplate testing

CSI087254	Proteus color kit	3 antigensx5 ml	3x100 tests
<i>Multiple kit containing the antigens OX19, OX2, OXK and the positive control</i>			

LISTERIA

Colourless suspensions for tube testing

CSI087249	Listeria plus	4x20 ml	4x40 tests
<i>Type 1 antigen O, Type 1 antigen H, Type 4b antigen O, Type 4b antigen H and polyvalent positive control</i>			

Sclavo Diagnostics International S.r.l.

Via Po, 26-28 Località Pian dei Mori
53018 Sovicille Siena (Italy)

for information:

ph +39 02 93 991 569

fax +39 02 93 991 393

sclavoexport@dgroup.it

www.sclavodiagnostics.com

aD²GROUP company

Distributed by



Sclavo Diagnostics International
is a certified company

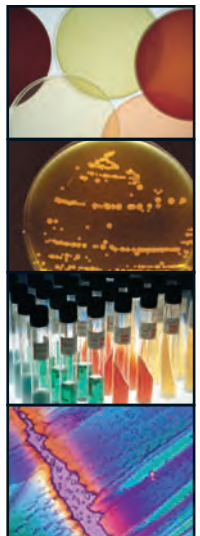

SDCI FEBRIL ANTIGENS 2011/01

